

Volta

- | | | | |
|------|--------------------------|------|-------------------------|
| (DE) | Montageanleitung | (HR) | Upute za montažu |
| (FR) | Notice d'instructions | (HU) | Szerelési útmutató |
| (GB) | Mounting instructions | (LT) | Montavimo instrukcija |
| (NL) | Montage instructie | (LV) | Montāžas instrukcija |
| (DK) | Monteringsvejledning | (PL) | Instrukcja montażowa |
| (FI) | Asennusohje | (RO) | Instructiuni de montare |
| (NO) | Montasjeanvisning | (SK) | Návod na montáž |
| (SE) | Monterings instruktioner | (RU) | Инструкция по монтажу |
| (IT) | Istruzioni di montaggio | (BG) | Инструкции за монтаж |
| (ES) | Instrucciones de montaje | (GR) | Οδηγίες χώνευσης |
| (PT) | Instruções de montagem | (SI) | Navodilo za montažo |
| (CZ) | Montážní návod | (EE) | Paigaldusjuhised |
| (BA) | Uputstvo za montažu | (IS) | Leiðbeiningar |

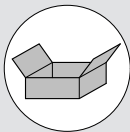

VZ456N/P

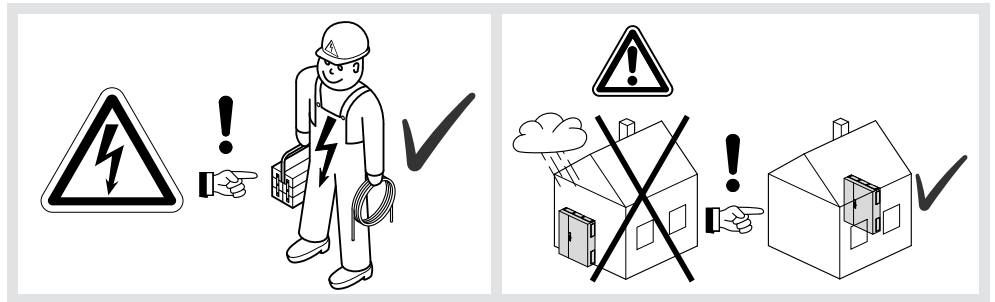